

FNR201610series

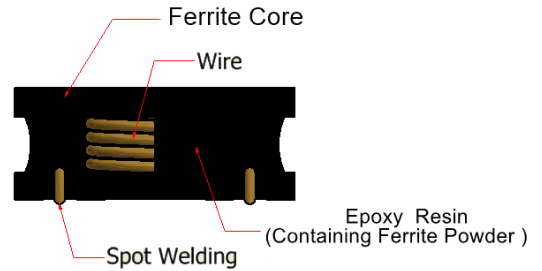

CONSTRUCTION



FEATURES

Magnetically structure
Low DC resistance
Large Current Capability

APPLICATIONS

Hard Disk Drives
Car audio equipment
Tablet PC
Navigation system
SSD
Touch Panel

SPECIFICATIONS

Operating temperature range	-40 to +125°C
Storage temperature range	Under 25°C
Packaging style	Taping
Quantities	2,000 pieces/reel

SHAPE AND DIMENSIONS

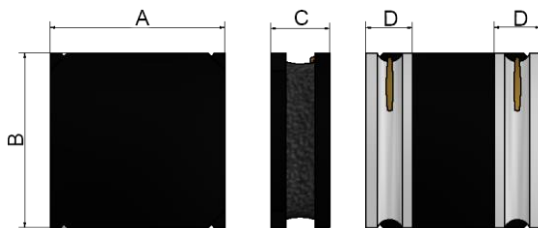

RECOMMENDED PATTERN

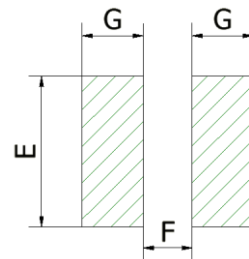

(Unit: mm)

TYPE	A	B	C	D	E	F	G
FNR201610	2.0±0.2	1.6±0.2	1.0max	0.6±0.2	2.1	0.7	0.7

PRODUCT IDENTIFICATION (ex.)

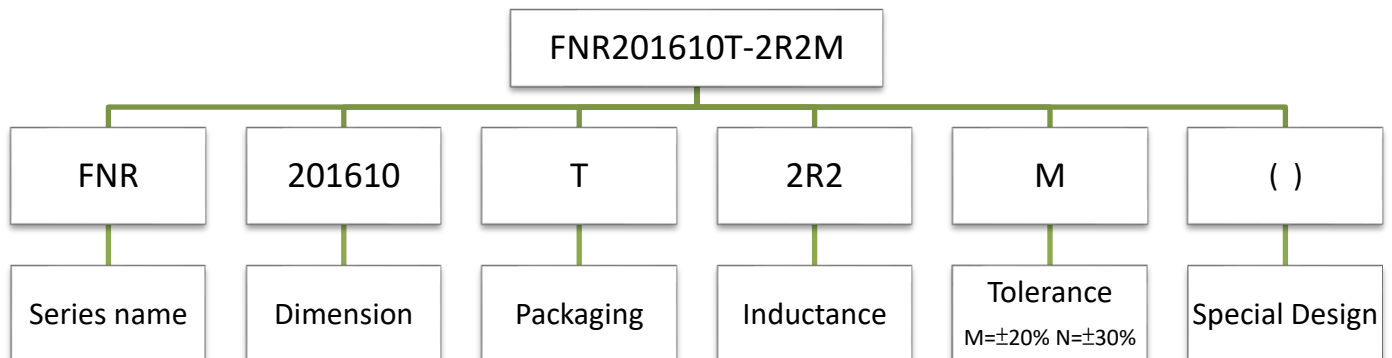

ELECTRICAL CHARACTERISTICS

Part No.	Inductance (μH)	Inductance tolerance	Test Frequency (MHz)	DC Resistance (Ω) ±20%	Saturation current Isat(mA)		Temperature rise current Irms(mA)	
					Typ.	Max.	Typ.	Max.
FNR201610T-R24N	0.24	±30%	1	0.026	4100	3700	3900	3200
FNR201610T-R47N	0.47	±30%	1	0.041	3100	2700	3000	2400
FNR201610T-1R0N	1.0	±30%	1	0.078	2100	1700	2000	1500
FNR201610T-1R8M	1.8	±20%	1	0.186	1400	1200	1400	1200
FNR201610T-2R2M	2.2	±20%	1	0.195	1300	1100	1300	1100
FNR201610T-4R7M	4.7	±20%	1	0.380	900	750	900	800
FNR201610T-100M	10	±20%	1	0.575	700	600	700	550

*The saturation current value (Isat) is the DC current value having inductance decrease down to 30% (at 25°C)

*The temperature rise current value (Irms)is the DC current value having temperature increase up to 40°C (at 25°C)

*Rated current: smaller value of either Isat or Irms.

RECOMMENDED SOLDERING CONDITIONS

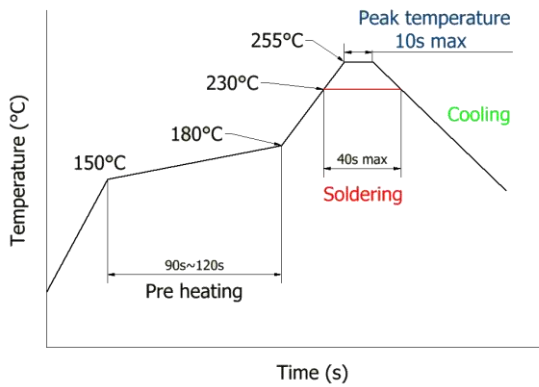

PACKAGE

(1) Taping specifications

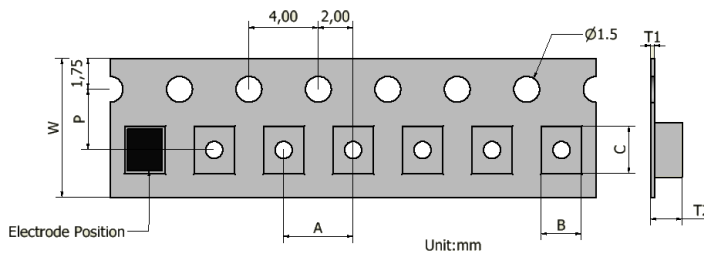

Type	W	P	A	B	C	T1	T2
FNR201610	8	3.5	4.0	1.85	2.45	0.23	1.2

(2) Reel Specifications

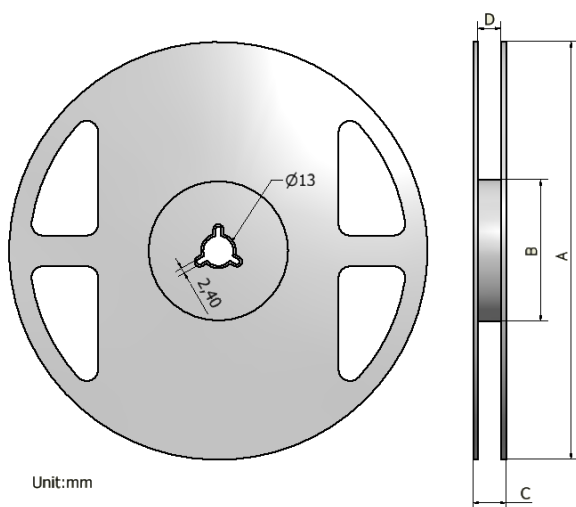

Type	A	B	C	D	Q'ty/Reel
FNR201610	180±0.1	60±0.1	14.5±0.1	10±0.15	2000

Label

Wire Wound Power Inductors
 FNR201610T-□□□M/N
 2,000PCS
 Lot No. _____
 FUMIWA TECHNIAL CO., LTD.

Type	Q'ty
PCS/Reel	2000
Reel/inner Box	10000
Inner Box/Carton	50000